



# CITY OF NAPOLEON GENERAL PERMIT APPLICATION

THIS APPLICATION IS FOR RESIDENTAL CONSTRUCTION INCLUDING BUILDING, ELECTRICAL,  
PLUMBING, MECHANICAL, DEMOLITIONS & REMODELING

DATE \_\_\_\_\_ JOB LOCATION 1214 W. Riverview  
 OWNER Sonja Eitzman TELEPHONE # 419-592-1266  
 OWNER ADDRESS 1214 W. Riverview  
 CONTRACTOR Max Buehner Building CELL PHONE # 419-392-6193  
 DESCRIPTION OF WORK TO BE PERFORMED Footek Tile  
 ESTIMATED COMPLETION DATE \_\_\_\_\_ ESTIMATED COST \$ 2500.<sup>00</sup>

**Affected Floor Area (AFA):** In existing structures, it is the area affected by the improvement, i.e. a new wall dividing a room (the AFA would be only the room and not all the rooms).

| DESCRIPTION  | FEE              | TOTAL COST   |
|--|------------------|--------------|
| <i>Addition &amp; Alterations</i> Square foot in (AFA) x \$0.05 = \$ | +                | \$25.00 = \$ |
| <i>Electrical</i> Circuits in (AFA) x \$3.00/Circuit = \$            | +                | \$25.00 = \$ |
| <i>Plumbing</i> Traps in (AFA) x \$3.00/Trap = \$                    | +                | \$25.00 = \$ |
| <b>Siding and/or Roofing</b>   | \$25.00          | \$           |
| <b>Windows/Doors</b>   | \$25.00          | \$           |
| <b>Decks</b>   | \$25.00          | \$           |
| <b>Garage and Shed over 250 SF (Detached)</b>                        | \$25.00          | \$           |
| <b>Electrical Service Upgrade</b>                                    | \$25.00          | \$           |
| <b>Water Heater</b>  | \$25.00          | \$           |
| <b>Furnace and/or AC Replacement</b>                                 | \$25.00          | \$           |
| MBP (100.3100.46510)   | <b>Subtotal:</b> | \$           |
| (100.0000.42700) PLUS Ohio Board of Building Standards Fee           | + 1%             | \$           |

**TOTAL FEE: \$**

**I FULLY UNDERSTAND THAT NO EXCAVATION, CONSTRUCTION OR STRUCTURAL ALTERATION, ELECTRICAL OR MECHANICAL INSTALLATION OR ALTERATION OF ANY BUILDING STRUCTURE, SIGN, OR PART THEREOF AND NO USE OF THE ABOVE SHALL BE UNDERTAKEN OR PERFORMED UNTIL THE PERMIT APPLIED FOR HEREIN HAS BEEN APPROVED AND ISSUED BY THE CITY OF NAPOLEON BUILDING/ZONING DEPARTMENT.**

*I hereby certify that I am the Owner of the named property, or that the proposed work is authorized by the Owner of record and that I have been authorized by the Owner to make this application as his/her authorized agent and I agree to conform to all applicable laws of the jurisdiction. In addition, if a permit for Work described in this application is issued, I certify that the code official or the code official's authorized representative shall have the authority to enter areas covered by such permit at any reasonable hour to enforce the provisions of the code(s) applicable to such permit.*

**I HEREBY ACKNOWLEDGE THAT I HAVE READ AND FULLY UNDERSTAND THE ABOVE LISTED INSTRUCTIONS.**

SIGNATURE OF APPLICANT: [Signature] DATE: 4-28-09

PRINT NAME: Neil Moore

|         |         |      |
|---------|---------|------|
| BATCH # | CHECK # | DATE |
|---------|---------|------|

**THE CITY OF NAPOLEON  
BUILDING & ZONING DEPARTMENT  
255 W. RIVERVIEW  
(419)592-4010**



---

**Inspections**

Page 1 of 1

**Address:** 1214 Riverview Ave. W.  
Napoleon, OH 43545

Printed: 5/26/2009

**Applicant:** Mock Buehrer Builders

**Permit Number:** PL2009-18

---

**Inspection Date:** 5/26/2009  
**Inspection Number:** INSP2009-66  
**Inspection Type:** Plumbing Final

**Inspector:** Marty Crossland

**Status:** Complete

**Passed?**

**Required Steps:**

**Comments:**

---

**Other Fields:**

DATE: 5-26-09  
INSTALLED BY: MOCK - BUEHNER BUILDERS  
INSPECTED BY: MURTY CROSSLAND  
11-20

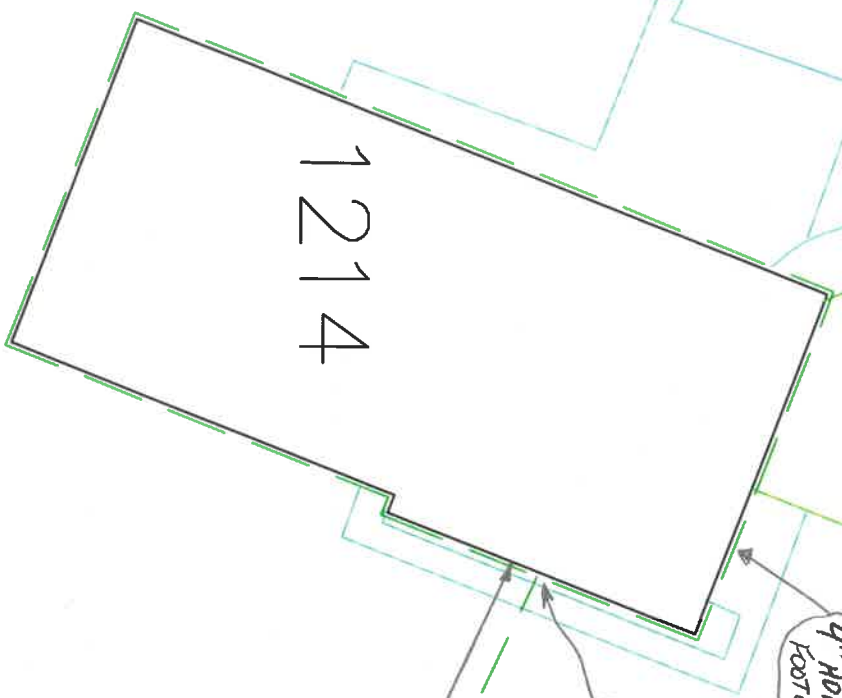

4" HDPE  
FOOTER TILE

2' DEEP  
FIL  
@ FOOTER  
TILE

4" PVC

8'

45' BAND  
3' DEEP FIL

22' BAND  
3' DEEP FIL

45' BANDS  
3' DEEP FIL

4" PVC

4.5'

1' DEEP  
TOP  
4"

WEST RIVERVIEW AVENUE

